



What: Stair #2 - Flooring Abatement

Where: All Floors (See plan attached. Typical for all floors)

Start Date: 12/14/2020

Impact: No Access Stair #2 - All Floors

Contacts:

- Vic Hoyecki – Project Superintendent – (203)943-2950
- Pam Buonocore – KGL Operations Manager – (203)915-4651
- Mark Veroneau – Yale Associate Project Manager – (475)241-2476

GENERAL NOTES - FLOOR PLAN

- DIMENSIONS NOTED AS "EQUAL" OR "EQ" WITHIN A ROOM REFER TO A DISTANCE RELATIONSHIP CONTAINED ONLY IN THAT ROOM AT AN OPPOSING OR PARALLEL WALL UNLESS NOTED OTHERWISE.
- TYPICAL CODE-REQUIRED MANEUVERING CLEARANCES FOR ACCESSIBILITY AT DOORS IS SHOWN IN THE CODE PLANS LEGEND. THE REQUIRED MANEUVERING CLEARANCES FOR EACH DOOR ARE SHOWN ON THE FLOOR PLAN OR LAYOUT DRAWINGS. THE CONTRACTOR SHALL BE FULLY RESPONSIBLE TO COORDINATE THE REQUIREMENT FOR MANEUVERING CLEARANCES WITH SUBCONTRACTORS, VENDORS AND INSTALLERS AND VERIFY THAT THE INSTALLED WORK WILL PROVIDE THE REQUIRED MANEUVERING CLEARANCES. REPORT ALL DEVIATIONS FROM THE MANEUVERING CLEARANCE REQUIREMENTS TO THE ARCHITECT. DO NOT PROCEED WITH THE INSTALLATION OF ANY WORK ENCRANCHING ON THE REQUIRED MANEUVERING CLEARANCES UNTIL THE ISSUE HAS BEEN RESOLVED WITH THE ARCHITECT. MAKE NECESSARY CORRECTIONS.
- DIMENSIONS SHOWN ON ARCHITECTURAL FLOOR PLANS AND ENLARGED PLAN DETAILS ARE TO FACE OF STUD, TO FACE OF MASONRY OR TO CENTER LINE OF COLUMN UNLESS OTHERWISE NOTED.
- ENSURE FINISH SURFACES ARE FLUSH AND SEAMLESS WHERE PARTITIONS AND/OR FURRING ARE COPLANAR.
- ALL PIPING, CONDUITS AND RELATED MECHANICAL AND ELECTRICAL ITEMS SHALL BE CONCEALED WITHIN PARTITION WALL ASSEMBLY IN FINISHED AREA, U.N.O.
- PROVIDE BACKING/BLOCKING TO SUPPORT ALL WALL MOUNTED ITEMS.
- ALL MECHANICAL PADS TO BE 4" HIGH MINIMUM, U.N.O. SIZE OF PAD TO BE VERIFIED BY CONTRACTOR.
- PITCH SLABS (AND OTHER FLOORS) TO FLOOR DRAINS, TYP.

No Access All Floors - Stair 2 Abatement Start Date: 12/14/20 (Monday)
Reopened Access to Users - Stair: 12/28/20 (Monday)

KGL Stair No. 2 Abatement Phasing Plan
Yale Kline Geology Laboratory Code Upgrades Project
New Haven, CT
Turner Project No. 201026
Data Date: December 2, 2020
By: VJH

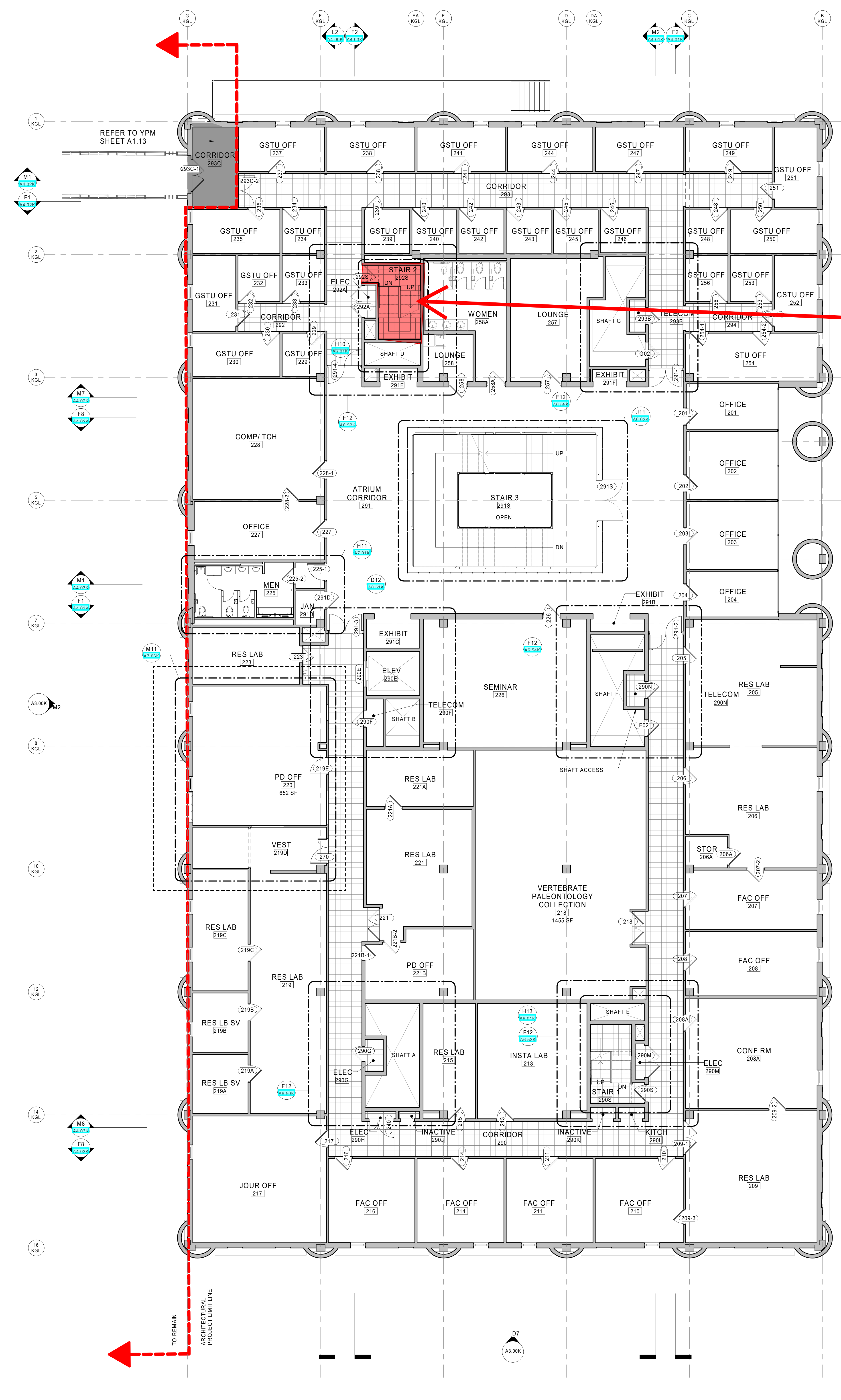

M1 2nd FLOOR PLAN
1/8" = 1'-0"

